



## PT210 Series Standard Strain Pressure Transmitter



### Features

- accuracy superior to 0.5% F.S
- strain wheastone bridge structure
- gauge pressure:0-10bar,0-600bar
- ingress protection:IP65
- multiple e-connection option
- multiple threaded connection options

### Applications

industry process measurement&control  
hydraulic pressure system  
industrial machinery manufacturing

### Description

This series uses high-quality 17-4PH material as elastic component. It can convert gauge pressure to standard voltage or current output via amplifying circuit and electronic compensation. It has high anti-interference, flexible working temperature and long-term stability.

### Technical Parameters

Attribute	Technical Parameters		
Pressure Range	0~10 bar,0~600bar		
Accuracy	±0.5% F.S		
Overload Capacity	1.5 times rated pressure		
Breakdown Pressure	3 times rated pressure		
Pressure Type	gauge pressure		
Electrical Environmental Temp	-25℃~ 85℃		
Mechanical Shock	100g/1msec		
Mechanical Vibration	≤20g(15-2000Hz)		
Temperature Drift	≤0.04% /℃		
Compatible Medium	all corrosive medium compatible with material1Cr18Ni9Ti and material 17-4PH		
Electrical Performance	2-wire	3-wire	3-wire
Output	4-20mA	0-10 V	0-5V
Response Time	≤3msec	≤10msec	≤10msec
Supply	10-30VDC	12-30VDC	10-30VDC
Overload Resistance	(U-10)/0.02Ω	>25KΩ	>25KΩ
E-Connection	lead-wire,M12×1 round connector,Hirschmann connector		
Ingress Protection	IP65		
Pressure Connector	G1/4,1/4NPT,G1/2,M20		



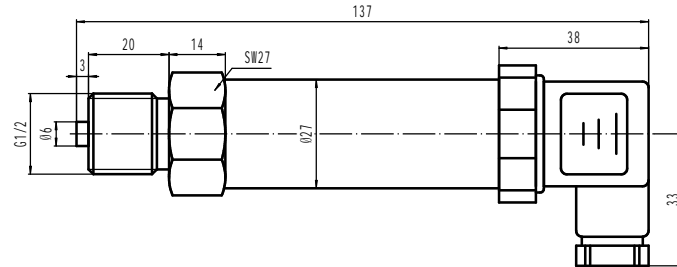

## External Dimension

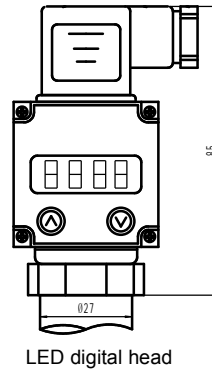
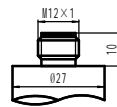
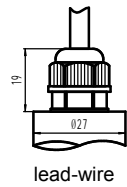

## E-Connection



Hirschmann Connector	2-wire	wire color	3-wire	wire color	
	1	E+	Red	E+	Red
	2	E-	Black	S+	Blue
	3			E-/S-	Black

M12 ×1 Round Connector(4-PIN)	2-wire	wire color	3-wire	wire Color	
	1	E+	White	E+	White
	2	E-	Brown	S+	Brown
	3			E-/S-	Green

Lead-Wire	2-wire	wire color	3-wire	wire color	
	1	E+	Red	E+	Red
	2	E-	Black	S+	Blue
	3			E-/S-	Black

E:power supply  
S:signal output

## Pressure Connector

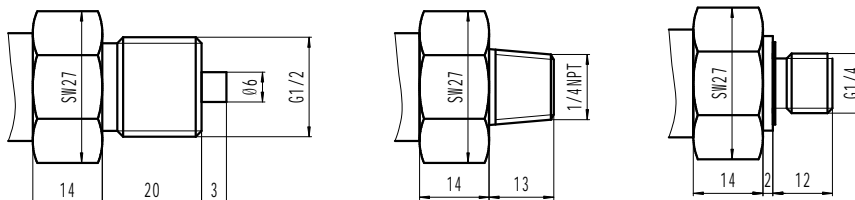



## Ordering Guide

Series Code		PT210	X	X	X	X	X	X	X	X	X
Pressure Unit	bar		B								
	MPa		M								
Pressure Range	on your request			X							
Process Connection	G1/4				G1/4						
	1/4NPT				1/4NPT						
	G1/2				G1/2						
	G1/4 internal thread				G1/4C						
	G1/2 flush diaphragm				G1/2S						
Signal Output	4~20mA				MA						
	4~20mA+Hart				H						
	0~10VDC				10V						
	0~5VDC				5V						
	0~20mA				2MA						
	1~5VDC				3V						
	0.5~4.5VDC				4V						
E-Connection	Hirschmann connector				2D						
	M12×14-pin round connector				T						
	Packard connector				P						
	water-proof lead wire X meters				MX						
	Hirschmann connector with LED				3D						
	2088 housing with LED digital display,lead wire x meters				8Mx						
	2088 housing,lead wire X meters				7Mx						
	5-pin standard aviation connector				5P						
	6-pin standard aviation connector				6P						
	LED digital display with alarm function				4D						
Safe Grade	None				Blank						
	Intrinsically Safe				IA						
	Exd				ID						
Housing Size	Φ27mm or 2088 housing				Blank						
	Φ38mm with "Z""S" potentiometer				W38						
	Φ44.4 welding shell with "Z""S" potentiometer				W44						
Sealing Way	standard end face sealing				Blank						
	standard end face sealing with damping				N						
	taper sealing				Z						
	O ring sealing				M						
Accuracy Grade	0.50%				Blank						
	0.25%				2A						

Note:

- 1.The wetted part material should be compatible with measured medium when selecting.
- 2.Condition limited to 4~20mA signal output,-30~70℃ environmental working temperature and no less than 20VDC power supply when mode "L" in the options of E-Connection is chosen.
- 3.Mode Ex in the options of E-connection represents x cable length in meters.
- 4.1 meter standard cable equipped when choosing mode P in the options of E-connection,contact us for extra.